

Certificate Authority Install guide – Windows

1. Download certificate from https://pki.rdto.io/CA/root_ca_1.crt
2. Double click on the certificate file to open it.

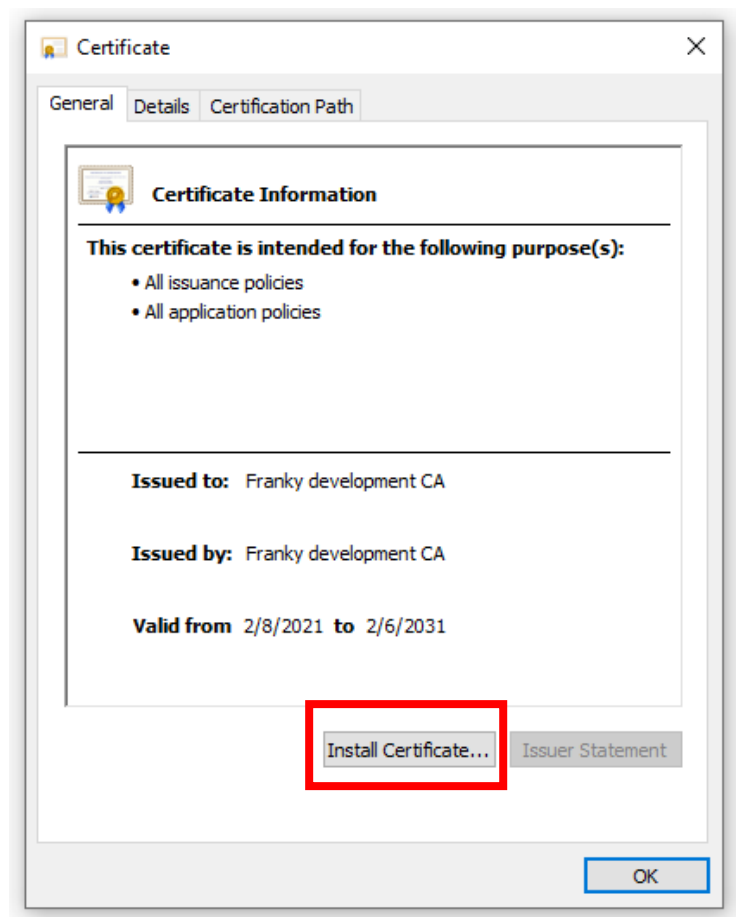

3. Click on “Install Certificate”



4. Select on “Local Machine” and click “Next” (You’ll need Administrator Privallages)

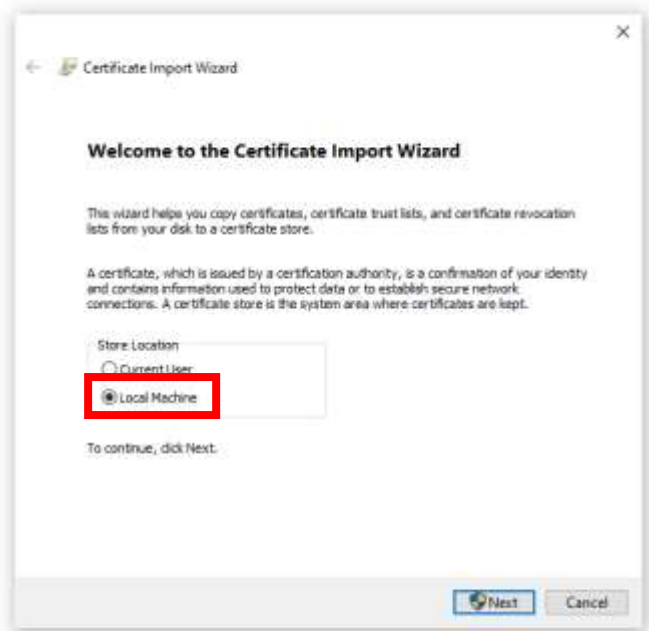

5. On UAC window, click “Yes”
6. Select “Place all certificates in the following store” and click “Browse...”

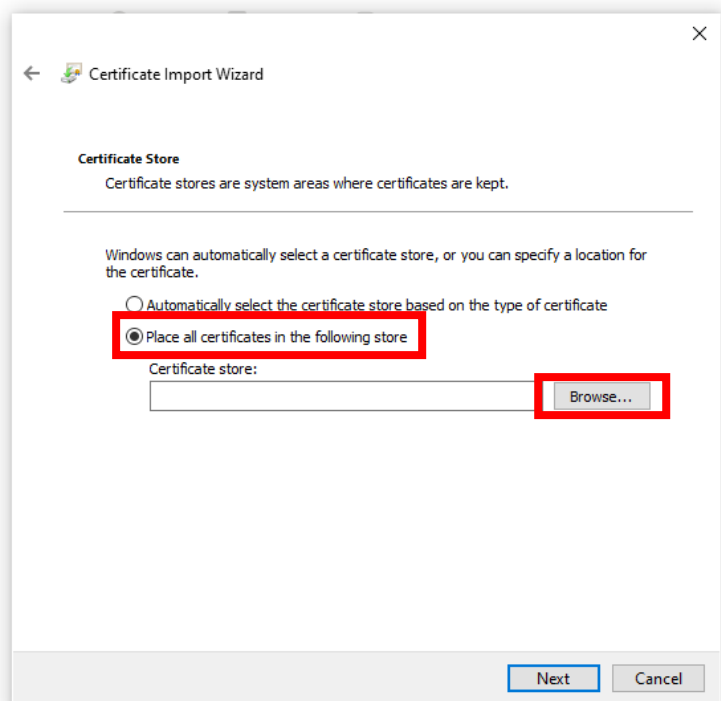

7. Navigate to “Trusted Root Certification Authorities” then click “OK”

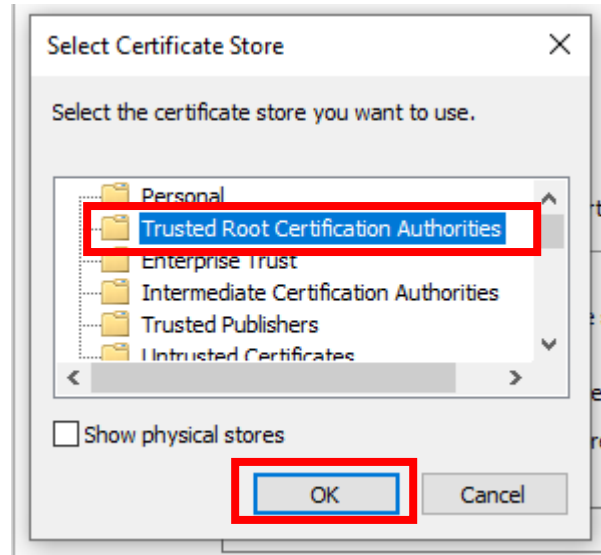

8. Click on “Next”

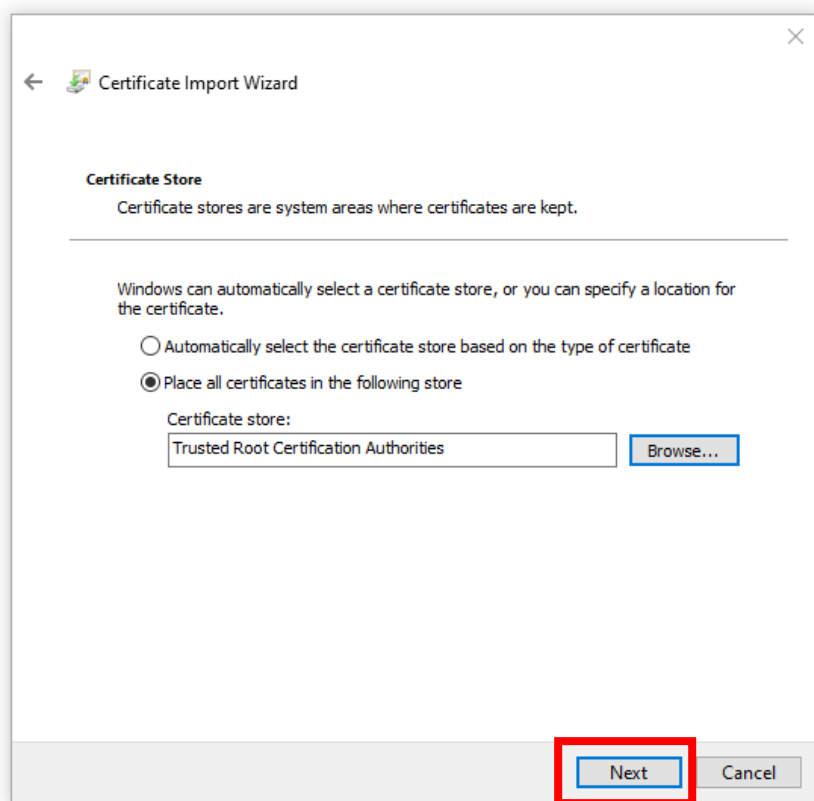

9. Click “Finish”

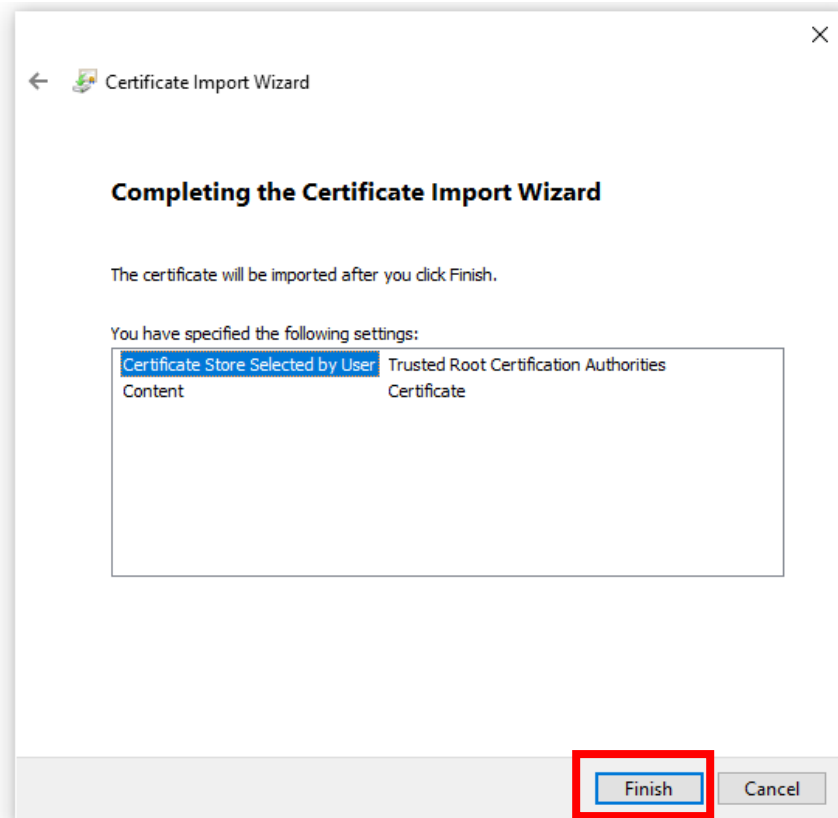

10. The import of CA certificate is success.